

SMOKE EVACUATION / ROOF ACCESS / DAYLIGHTING / NATURAL VENTILATION

PYROTOP

CE
0333



SKYDÔME[®]
La sécurité en toute clarté



PYROTOP WITH OPTIONS



PYROTOP ANGLED ADAPTER PLATE VERSION WITHOUT OPTION

The **PYROTOP** is a unit designed principally for heat and smoke evacuation, and for roof access in stairwells. It is used on flat and low slope roof with waterproofing and on tiled or slate pitched roofs for all types of building:

- public access buildings;
- industrial buildings;
- commercial buildings, offices;
- residential buildings.

The **PYROTOP** is a complete unit specially designed for stairwells.

SMOKE EVACUATION / ROOF ACCESS / DAYLIGHTING / NATURAL VENTILATION

PYROTOP

CE
0333

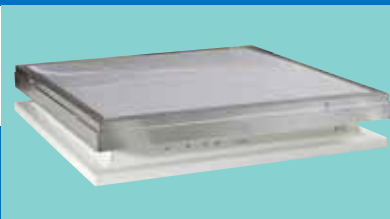

1

ADVANTAGES

The **PYROTOP** is a unit specially designed for stairwells with an opening surface of **100 x 100**.

Integrated mechanisms: the opening and closing mechanisms of the **PYROTOP** are completely contained within the 310mm height of the kerb in the opened or closed position. This means that they do not impede the passage of other networks and the use of other equipment under the ceiling.

High resistance to corrosion: the galvanised steel kerb is assembled by crimping techniques. This method of assembly, used in the car industry, avoids the use of welding techniques which require subsequent reconditioning to achieve a level of protection equal to galvanisation. It allows the **PYROTOP** to have an excellent resistance to weathering and corrosion, even when scratched.

Colour finish: the **PYROTOP** is available in galvanised steel or, upon request, in steel and pre-coated in CLASSIC WHITE SKYDOME colour. It can also be painted after manufacture in one of the main RAL colours.

The **PYROTOP** is getting an architectural feature of the roof.



Adapted to the roof: Ideal for new roofs. The standard kerb is 310 mm high with a foot of 90 mm.

For refurbishment and renovation works, adapted on an existing kerb:

- The adapter plate is 130 mm high with a foot of 83 mm (other foot sizes are available upon request). **The design of our 100 x 100 cm adapter plate allows the adapter or the covering kerb to be passed inside an internal opening measuring 100 x 100 cm.**

NEW

PYROTOP - Height: 310 mm

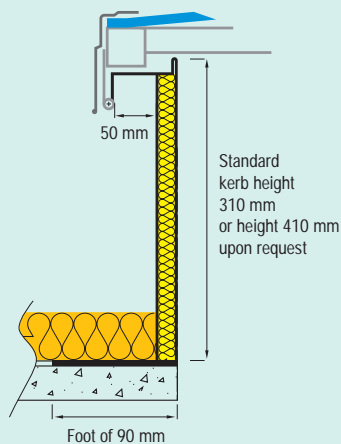

RENOVATION

**ADAPTER PLATE PYROTOP
Angled kerb - Height: 130 mm**

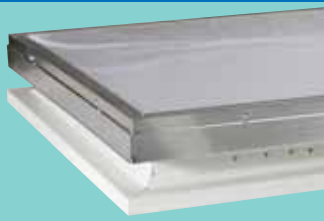
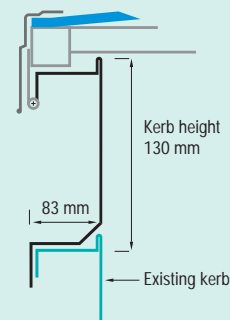

The PYROTOP consists of:

- **A galvanised steel kerb**, this is the main component of the unit. The opening part of the unit and the mechanical and oleo-pneumatic opening system are fitted to the kerb. The kerb of the **PYROTOP** is equipped with a pulley as standard. The straight side kerb is covered on the outside by bitumen-surfaced thermal insulation designed to accept torch-on waterproofing membranes. In the **PYROTOP** Adapter Plate version, the option of an insulated kerb is available on request.
- **A tubular opening frame in galvanised steel**: the opening frame is equipped with a thermal fuse (security option certified CE) as standard to which the steel cable is centrally attached.
- **Glazing**: as standard version either 10mm reinforced, structured opalescent polycarbonate sheet (PCA) tested to 1200 joules, or double dome polymetacrylate de methyle (PMMA). As option, 10 and 16 mm structured polycarbonate (triple or quadruple-walled) for better thermal resistance. To choose the type of glazing required, see the table entitled "Glazing Performance". The positioning of the glazing and the design of our units reduce the build-up of condensation as air circulates between the frame and the kerb.
- **Aluminium beading frame**: this holds the glazing in place and protects edges from lateral impacts. It also improves the aesthetic appeal of the **PYROTOP**.

4 FUNCTION

In case of fire, the thermal fuse and/or the emergency release of the winch causes the **PYROTOP** to open in accordance with the type of control used. The force necessary to open the unit is supplied by gas filled cylinders, held under pressure in the closed position. This system allows the unit to open to 125°.

If the unit is opened (apart from melting of the fuse), it can and must be closed again using a winch at ground level.

The thermal fuse is imposed by the norm NF EN12101-2 on all units, apart of specific restrictions: (contact us).

5 GLAZING PERFORMANCES

TYPE OF GLAZING	THERMAL TRANSMISSION U (W/m ² °C)	LIGHT TRANSMISSION (%)	FIRE CLASSIFICATION*	ACOUSTIC (db (A))
Double dome PMMA (Polymetacrylate methyle)	3,1	76	Tests in progress (M4)	19
10 mm structured polycarbonate – clear	3,1	85	Bs1do	17
10 mm structured polycarbonate – opal	3,1	62	Bs1do	17
10 mm structured polycarbonate – 4-walled opal	2,5	55	Bs1do	17
16 mm structured polycarbonate – opal	2,3	57	Bs1do	21

* Euroclass Classification

() Former Fire classification

6 PERFORMANCES

LOADS kg/m ²	WIND LOADING (DEPRESSION TEST)	RELIABILITY TEST	HEAT RESISTANCE
25 kg/m ² for all glazing	WL 1500	Re 300	B 300

In standard, the **PYROTOP** is of type B and T (00)

OPENING DIMENSION cm x cm	A _v (GEOMETRIC OPENING SURFACE) in m ²
100 x 100	1

See the conformity certifications of the Aa on our website: www.skydome.eu



7 APPROVAL

Laboratory tests guarantee that the **PYROTOP** resistance and performance levels are in accordance with the most restricting current legislations, when installed in conformity with the DTU 43-3.

The **PYROTOP** has the Product Certification CE NF EN 12101-2 N°0333 CPD219 053 with all our glazing (see table), including safety options:

- Thermal fuse.

The conformity certifications of the norm NF EN 12101-2, 1200 joules and fire rating data are available on our website: www.skydome.eu under the heading “Espace Partenaires” (Partner Information).

Reminder IT 246: Article 3.8 Characteristics of smoke evacuation units

"The smoke evacuation units of reliability class **Re 300** (300 cycles of security process).





The bi-function units, used for ventilation, are opened 10 000 times during the ventilation tests.

The classification of the snow load is **SL 250** (25 daN/m²) for altitudes lower or equal to 400 m,

SL 500 (50 daN/m²) for altitudes over 400 m...

The units are inside temperature class **T00** (0°C) and heat resistance class **B₃₀₀** 30 (300° during 30')."

- Grab handle in galvanised steel.
 - Ladder attachment bar (BAE) in galvanised steel.
 - Pre-painted kerb in CLASSIC WHITE SKYDOME.
 - Opening grill (tested to 1200 joules) (galvanised or pre-painted).
 - Domes 1200 joules.
 - Pyramid domes.
 - Adapter plate insulation.
 - Foot lengths from 83 mm to 180 mm.
 - PCA 10 Black, PCA 16, etc.
- Possible option:**
- Technical solution to adapt unit to a roof with PVC waterproofing.

- Certified  winch kit with mechanical release - ref. XKT 101
- Certified  winch kit with pneumatic release - ref. XKT 102
- Certified  winch kit with electromagnetic release (24/48 volts emitting/breaking) - ref. XKT 104
- Certified  winch kit with electro pneumatic release - ref. XKT 103

Installation should be carried out in accordance with current regulations. Decks should be sound, resistant and in accordance with the requirements of current decking standards and the installation guide. Maximum roof slope: 25°, i.e. 45%. When the roof slope is less than 25°, the hinged side of the unit must be parallel to the slope. If the roof slope is less than 3°, there are no restrictions.

Fixing: in accordance with the current DTU series 43, in the case of the standard kerb, on steel, wood or concrete deck.

Waterproofing seal:

- The bitumen-faced insulation on the standard kerb guarantees a seal with waterproofing detailing material.
- Zinc flashing should be installed in situ to create a seal with roof tiles or slates.
- A co-laminated metal sheet is used for PVC membranes.

Maintenance: the installation has to be checked at regular intervals and a preventive maintenance check should be scheduled for at least once a year (refer to current regulations for the type of building).



12 GEOMETRIC DIMENSIONS

DIMENSION OF OPENING A x B* (cm)	E (cm)	H (cm)		H1 (cm)		Weight	
		in DD	in PCA	in DD	in PCA	in DD	in PCA
100 x 100	135	55	41	37	23	42	45

* B is the longest, hinged sides of the unit.

PYROTOP

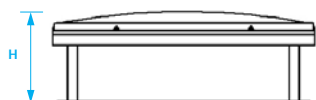
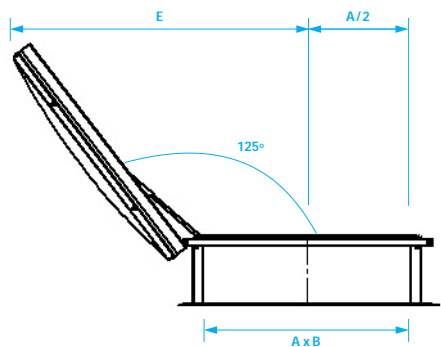

ADAPTER PLATE PYROTOP

