

**PUT INTO SERVICE:**

Once the unit assembled, make one or several test(s) to verify the good functioning of the unit. In particular, verify the mechanical and pneumatic opening and closing of the unit as well as its locking function.

MAINTENANCE AND PERIODIC CHECKINGS:

All our products are not guaranteed in case of an exposure likely to change the initial characteristics of one element or one function of the unit.

The working, maintenance and periodic verifications' operations should be done following the current texts' and norms' requirements as well as the following AMS prescriptions:

Proceed to a minimum of 2 times per year of an opening/closing in security position of the unit.

Verify especially the state of the articulations, hinges, as well as the pneumatic jacks' rod. It is important to maintain these elements lubricated (grease, oil), except the jacks' rod.

Verify the tightening of screwed elements. (Links ...)
Verify the efficiency of the locking system.

When the rod of the pneumatic jack is scratched, distorted or if there is a presence of leaks, replace it.

Do not clean the jack's rod with a solvent product. It could damage the joints.
Do not paint the jack's rod.

The verifications' operations of the unit are of minimum 1 time per year.

REPLACEMENT:

All the components of the smoke evacuation unit are available upon request at AMS.



Impasse des Herbues ZA de l'Essart 21600 OUGES
Tel. 0033 3 80 79 25 50 - Fax. 033 3 80 79 25 45
E-mail: contact@ams-industrie.com

N° of certificate: 0333 CPD 219 022
Norm of reference: NF EN 12101-2

Year of certificate: 2006

INSTALLATION AND MAINTENANCE NOTICE OF

ARCADEF EVOLUTION PNEUMATIQUE

The following notice is not a contractual document; the manufacturer reserves the right without prior notice to do any modification.



Impasse des Herbues - ZA de l'Essart - 21600 OUGES
Tel.: 0033 3 80 79 25 50 - Fax: 0033 3 80 79 25 45 E-mail: contact@ams-industrie.com
S.A. au capital de 62 000 € - R.C.S. DIJON B 389 873 761 - SIRET 389 873 761 00032 - APE 281 A



SUMMARY:

INTRODUCTION:	Page 3
PRECAUTIONS OF THE SUPPORT:	Page 3
DESCRIPTION OF THE « CE » LABEL:	Page 4
THE RANGE:	Page 5
INSTALLATION OF THE UNIT:	Page 6
ASSEMBLY AND CONNECTION:	Page 7
LIST AND COMPONENTS LOCATION	Page 7
ASSEMBLING STAGES	Page 8-10
INSTALLATION OF THE DEFLECTORS	Page 11
PUT INTO SERVICE:	Page 12
MAINTENANCE AND PERIODIC CHECKINGS:	Page 12
REPLACEMENT:	Page 12

INSTALLATION OF THE DEFLECTORS:

The deflectors could be of two different types
(Depending on the choice made)
In aluminium or in structured polycarbonate
But in identical forms.

In both cases, the installation keeps the same.

Be informed:

For the opening panels of the « CE » vault, 6 deflectors are supplied, (their supports are drilled in factory).

These are composed of: 2 deflectors of 850 or 1210mm (depending on the span)
 4 deflectors of same dimension (Symmetrical 2 at 2).

Installation of the deflectors:

Stage 1: The deflectors of dimensions 850 or 1210mm are positioned on the top and middle of the external joints' covers (fix) of the opening panel.
Place the deflector (support in « L » pointing towards the opening panel) then drill the joint's cover.
Fix the supports on the joint's cover with the supplied rivets diameter 4.8mm.

Photo n°1

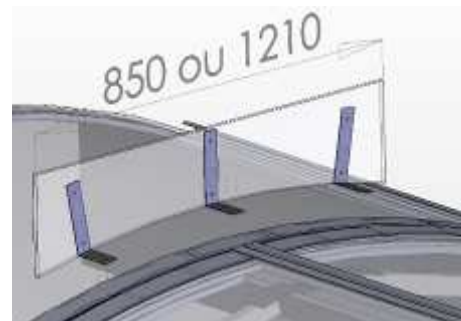
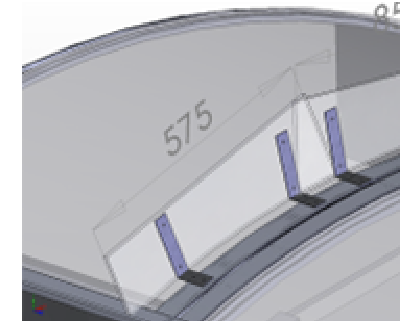

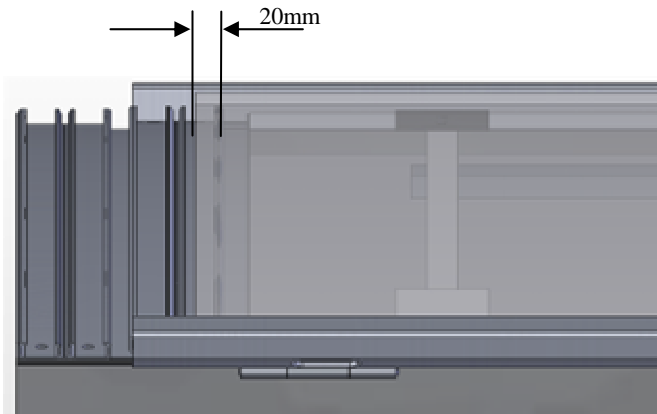



Photo n°2



Stage 2: For the extremities' deflectors, the installation procedure keeps the same.
(The drilling and the riveting are obligatory).
Position the deflectors such way that you do not have space between each deflector.
So an overlapping is imperative. (A binding between the deflectors is not necessary). If needed, adjust the length of the extremities' deflectors on the opening panel.

Stage 5: Put in place the structured polycarbonate plates  printed side on the outside by respecting a 20mm hold on each side of the plate.



Stage 6: Position the joints' covers  perpendicularly to the arches of the opening panels and fix them on the place of the drillings with the supplied stainless steel screws TC5.5*25.

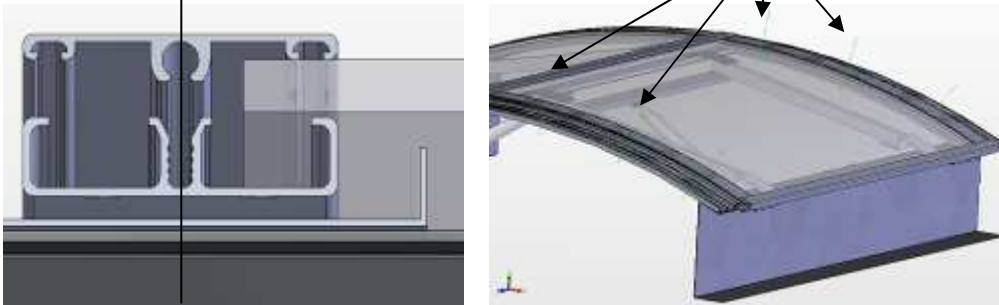

INTRODUCTION:

The smoke evacuation unit with double opening panels of the range ARCADEF EVOLUTION PNEUMATIQUE is a unit working on internal and/or external pneumatic energy according to the norm NF EN 12101-2.

The availability of the energy source must be assured.

The unit has to be installed in accordance with the norms, technical instructions, and all rules or texts applied.

PRECAUTIONS OF THE SUPPORT:

The support getting the unit has to be realized following the normalised tolerances of the building construction.

The installation of the unit has to be done according to the following rule:

Rule: The maximum slope authorised is 20° (that is to say 36.3%) whatever the installation configuration of the opening panel.

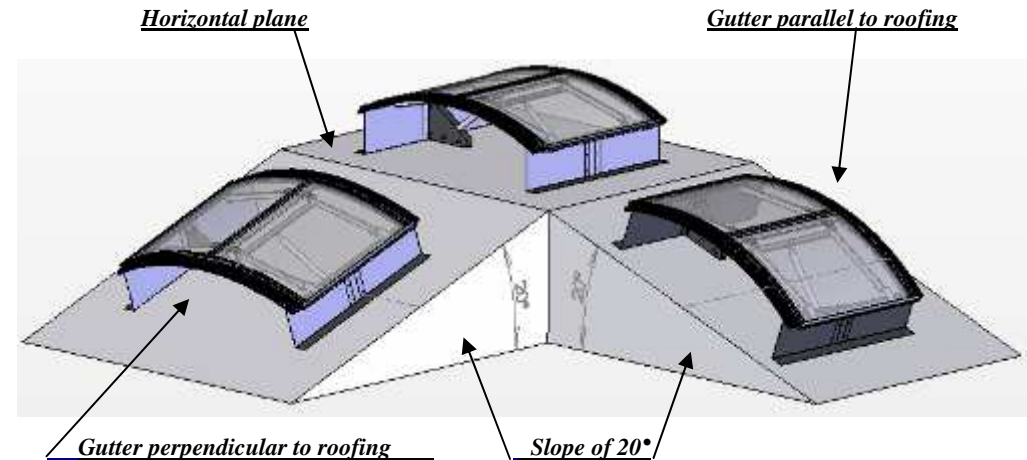

DESCRIPTION OF THE « CE » LABEL:

- ① Number of certificate and its obtaining date.
- ② Norm of reference in application.
- ③ Commercial name of the unit.
- ④ Opening Surface, (Aa).
- ⑤ Respectively:
 - Type of opening unit.
 - Classification of the wind loading.
 - Classification of the snow load.
 - Classification of inside temperature class.
 - Classification of reliability class.
 - Classification of heat resistance.
 - Classification of fire reaction of the unit's materials, following the applied European norm.
- ⑥ N° of production order.
- ⑦ Article Code (for the traceability of the unit).
- ⑧ Description of the security options:
Operating Temperature of the thermal fuse option.
Presence or not, of a position contactor.
- ⑨ Production date of the unit.

 Imprime des Herbes ZA de l'Essart 21600 OUGES Tél. 03 80 79 25 50 - Fax. 03 80 79 25 45 E-mail : contact@ams-industrie.com	
N° certificat	① 2006
NF EN 12101-2:200x	②
Dispositif d'évacuation naturelle de fumées et de chaleur	
③ ARCADEF EVOLUTION PNEUMATIQUE	
Aa = XX m²	④
type B; VVL 1500; SL 500; T(0); RE 300; B 300; Ax	⑤
OF0511083XX	⑥
Code: 8RXXXXXXXXX	⑦
Options de sécurité: T=xxx; contacteur de position	
⑧	
Date de fabrication: Date	
⑨	

Stage 3: Position and fix (on the top of kerb and in the middle of the opening panel) the supports on the inside of the kerbs with 12 auto drilled screws 6.3*25 (6 per support) on the factory drilled places.

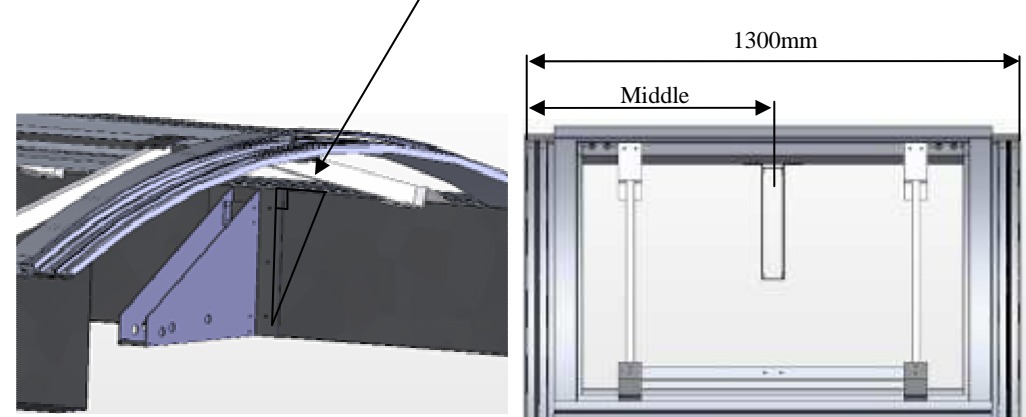

Stage 4: Put in place the pneumatic jacks
 1/ On the supports (thanks to the turning links),
 2/ Then on the opening panels in the piece already assembled.

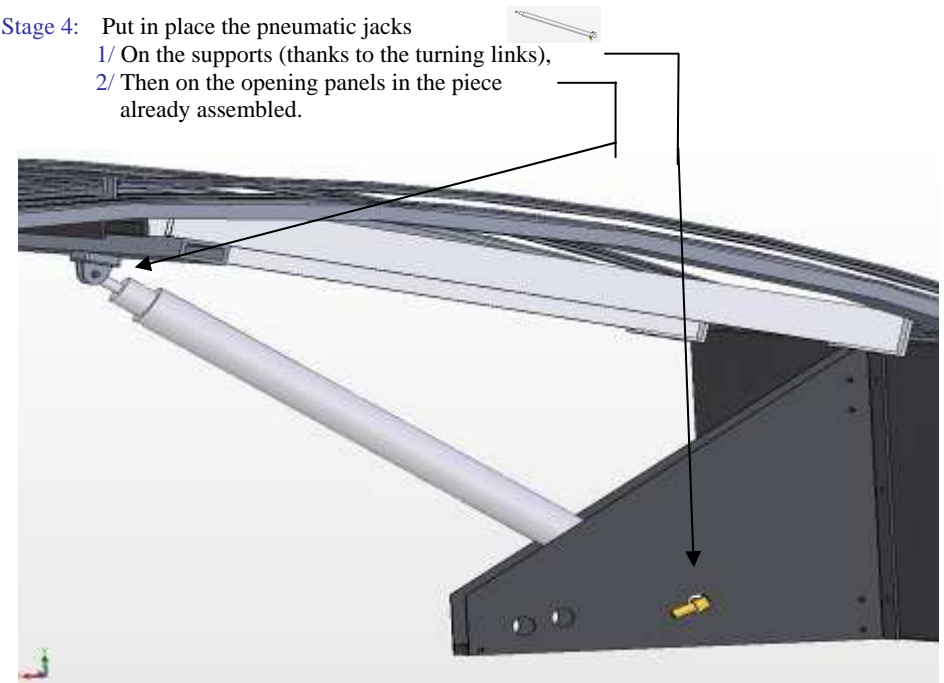

(If needed, make an adjustment of the screw head in order to have a good locking.)

ASSEMBLING STAGES:

Stage 1: Position the fixed part (H arched in factory)  on the planned place on the vault and fix it with the 8 auto drilled screws 6.3*25 on the kerb on the factory drilled places.

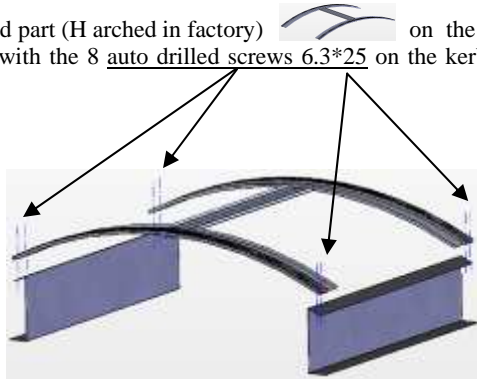

Stage 2: Position the 2 opening panels  by respecting the lateral spaces of 15mm and as well a roofing space of 15mm.

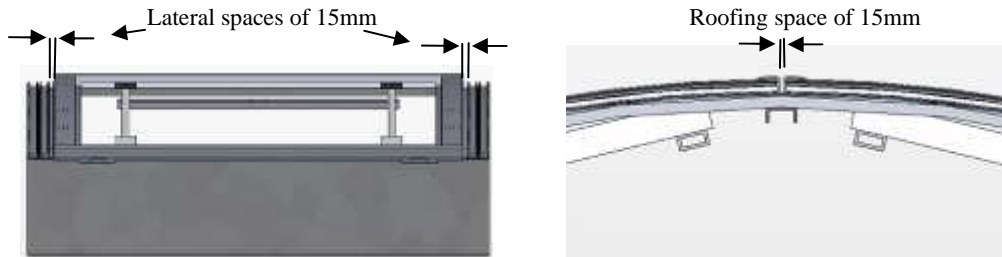

After the positioning of the two opening panels, fix the hinges on the kerb with the screws TH 6*16 + nuts + washers. (2 per hinge).

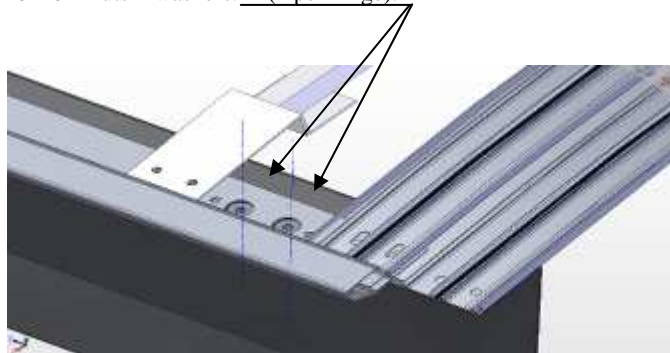

THE RANGE:

The characteristics of entries of the unit are available on the CE marked label located on the inner side of the H arched structure.

OPENING SURFACE			Pneumatic Jack		Opening	Closing	Cartridge (Used during the tests)
La in mm	Lo in mm	Surface of an opening panel (m²)	Ø jack (mm)	Volume (In Litre)	Pressure for 50 Kg/m² (Bar)	Pressure (Bar)	Gram (g)
1500 ≤ Width ≤ 3000	1300	1.02 ≤ Surface ≤ 2.02	40	1.376	15	7	100

« Lo » is the length of the unit (Fixed dimension of 1300mm, opening of 1000mm).
 « La » is the width (span) of the unit.

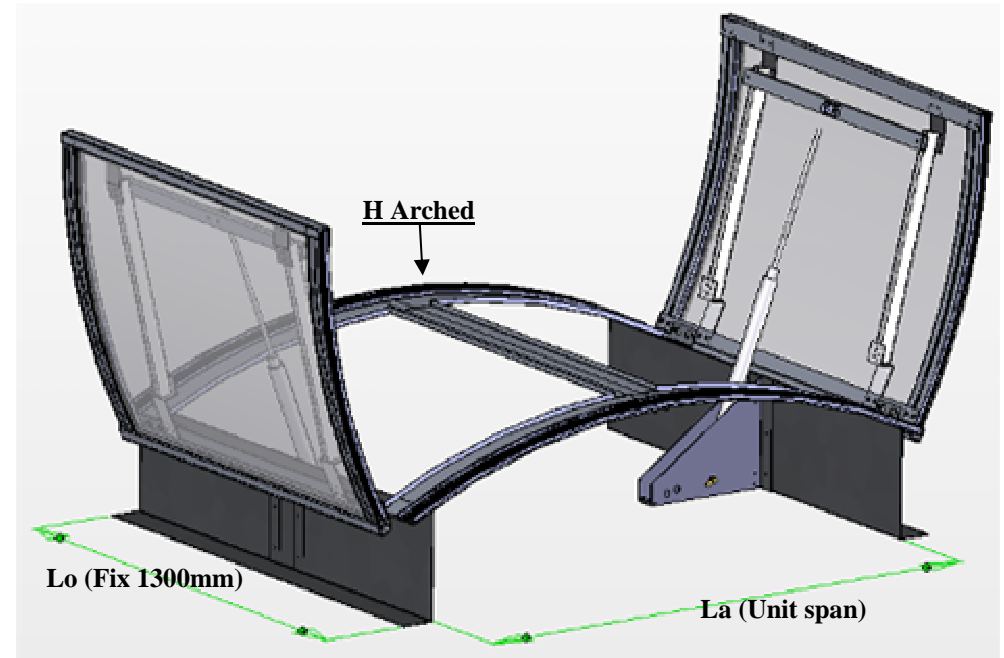

The complete range has a snow load capacity of 50Kg/m².

INSTALLATION OF THE UNIT:

Any operation that could damage the mechanisms and/or the structure of the unit is forbidden. AMS could not be considered responsible for the incidents resulting from these operations.

The installation of the ARCADEF EVOLUTION PNEUMATIQUE according to its support:

Trimmer-joist: Thanks to auto drill screws or rivets or other bolts by keeping **a maximum space of 330mm between 2 fixations.**

Ribbed steel sheets: Thanks to auto drill screws or rivets or other bolts by keeping **a maximum space of 330mm between 2 fixations.**

Concrete support: Thanks to adapted fixations by keeping **a maximum space of 200mm between 2 fixations.**

The insulation, eventually present on the unit, has a bitumen surface designed to accept torch-on waterproofing membranes.

The installation of the ARCADEF EVOLUTION PNEUMATIQUE in ADAPTER PLATE VERSION:

The prescriptions of the spaces described above are identical for the adapter plate version subject to an installation on an adequate existing support, that is to say: in steel, in concrete, in wood, or in all types of material having passed with success the test of thermal distortion described in the PEU (Unified Tests Procedure) smoke evacuation units.

The Av (Geometric Surface) of the support /existing kerb must be higher or equal to the Av of the adapter plate kerb.

The smoke evacuation units have to be fixed and waterproofed according to the defined prescriptions in the applied D.T.U waterproofing... (Unified Technical Document).

Diagrams of fixing principle of a unit according to its version:

Diagram 1: Standard kerb

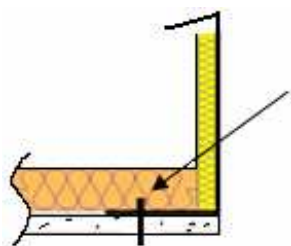

Fixing Side

Diagram 2: Adapter Plate Version

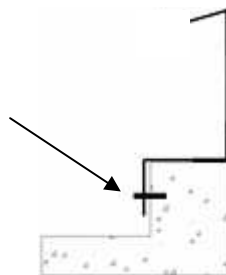

Other places of fixing may produce water leaks.

ASSEMBLY AND CONNECTION:

The unit is delivered ready for installation.

For the connection of the unit and its options to the pneumatic security supply, please refer to the current norm.

LIST AND COMPONENTS LOCATION:

REP1:	Fixed Part (H arched in the factory) 1 unit	
REP2:	Opening panel pre-assembled in factory 2 units	
REP3:	Structured polycarbonate plate 2 units (Width 1070mm)	
REP4:	Support 2 units	
REP5:	Pneumatic jack opening/closing (Including 2 turning links) 2 units	
REP6:	Aluminium joint's cover 4 units	

Location of the components on the assembled opening panels.

